

montážny návod

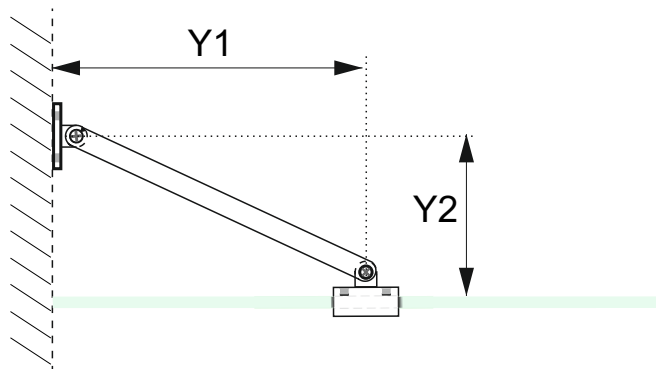
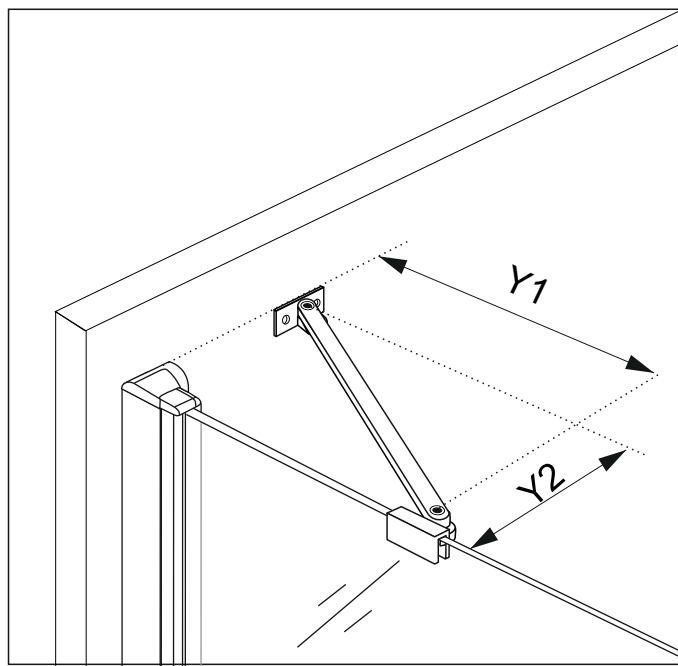

Rozmer (cm)	Y1	Y2
	Montážny rozmer od steny po konzolu (cm)	Montážny rozmer od konzoly po sklo (cm)
C33 - 30	25,0	15,0
C33 - 40	36,0	15,0
C33 - 50	46,5	15,0
C33 - 60	57,0	15,0

ROZPERNÁ TYČKA ROHOVÁ HRANATÁ

C33 - 30,40,50,60 cm



POZOR!

Všetky komponenty uvedené v návode majú svoju funkciu a sú dôležité. Použite časti tak, ako je uvedené v návode. Každý komponent je nutné použiť.

Komponenty balenia.

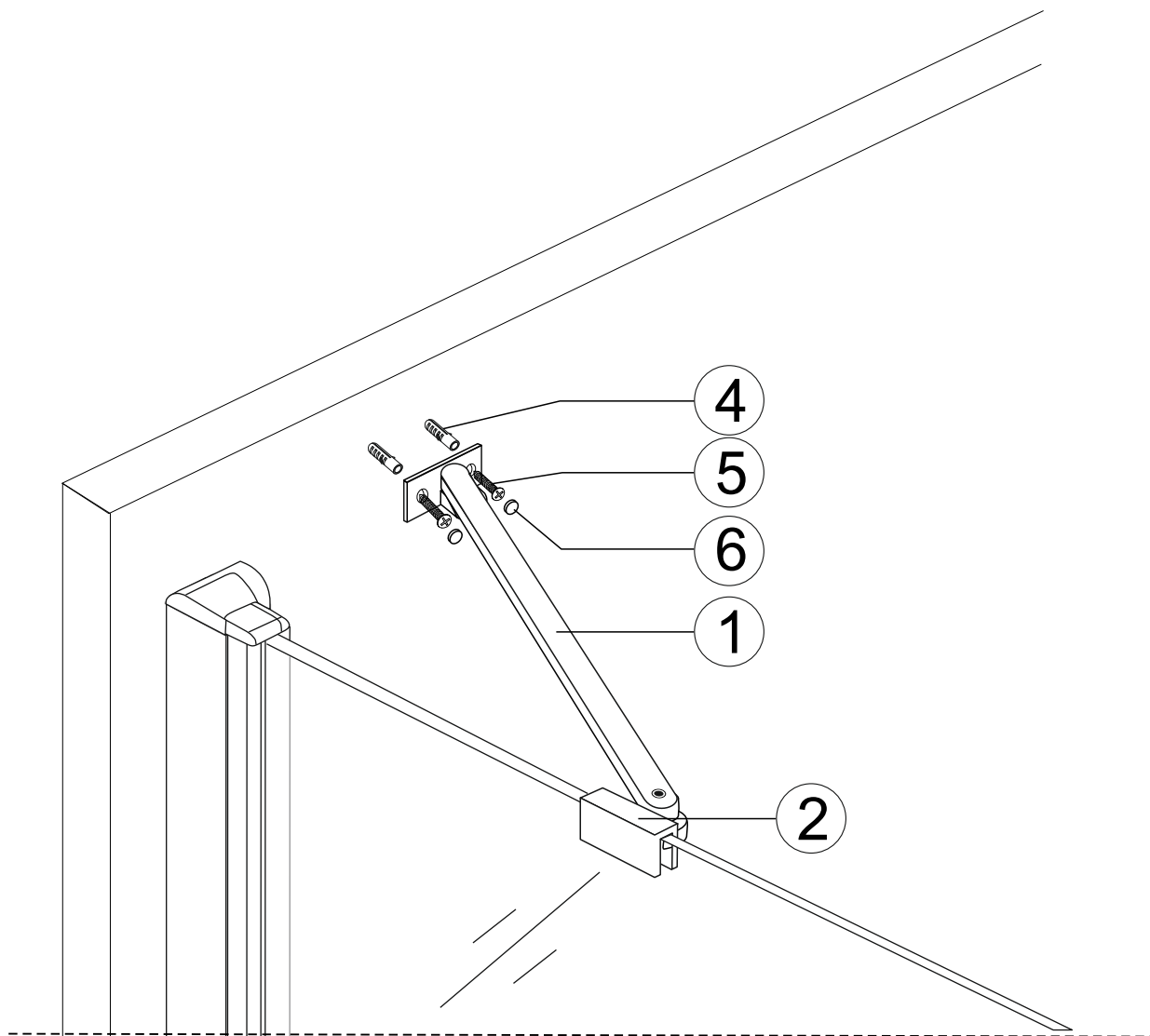

 Konzola je v balení zmontovaná. Komponenty konzoly sú označené pre uľahčenie montáže.

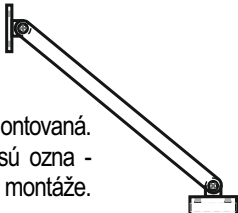

1 1 ks

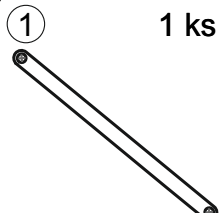

2 1 ks

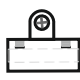

3 1 ks

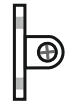

4 2 ks

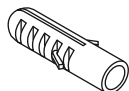

ø6x30

5 2 ks



ST4x35

6 2 ks



KRYTKA

7 1 ks

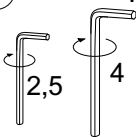

2,5 4

IMBUSOVÝ KLÚČ

8 1 ks

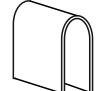

TESNENIE

ROZPERNÁ TYČKA ROHOVÁ HRANATÁ

C33 - 30,40,50,60 cm

Pomocné náradie používané pri montáži konzoly :

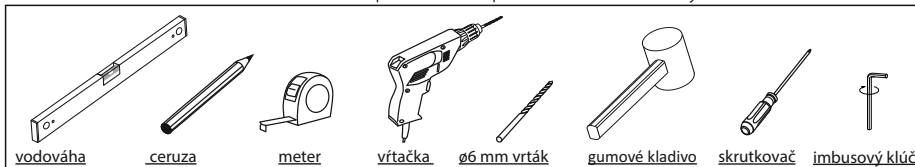

Montáž.

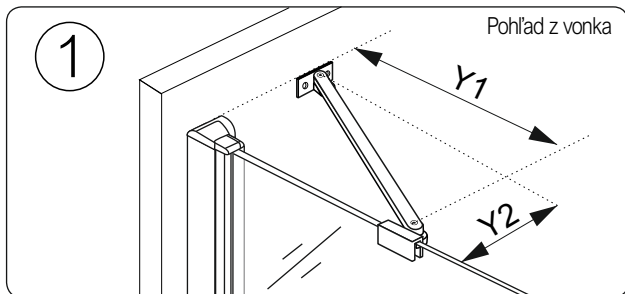

Y1 = montážny rozmer od steny po konzolu
Y2 = montážny rozmer od konzoly po sklo

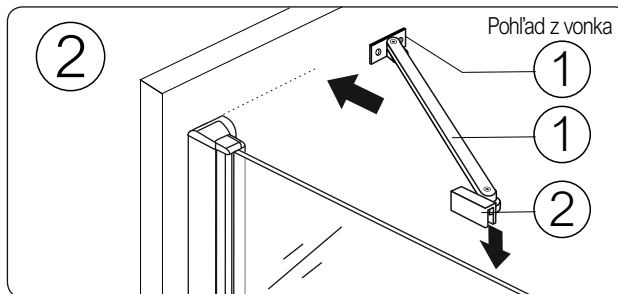

Konzoly diel č. 2 nasunte na pevné sklo a diel č.3 priložte ku stene.

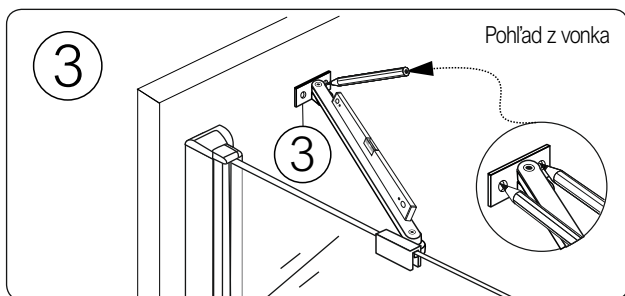

! Dbajte na dodržanie roviny.
Na koncovke č.3 označte diery vrtania.

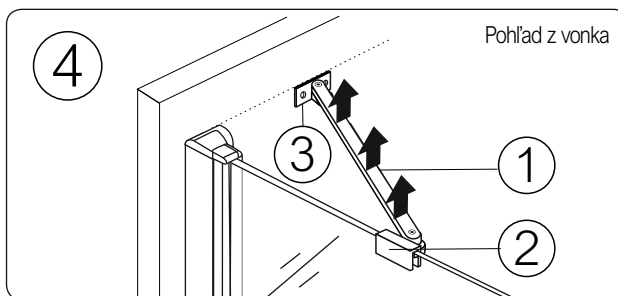

Po označení dier vrtania konzoly C33 dajte mimo montážny priestor.

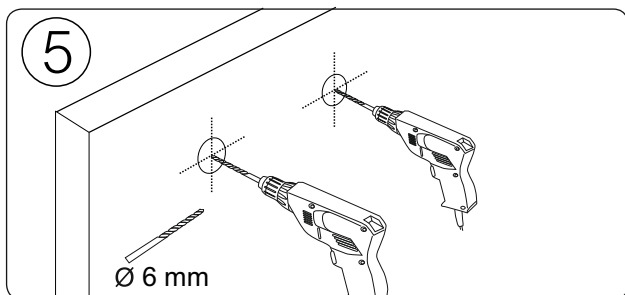

Vyvrťajte diery na uchytenie koncovky č.3.

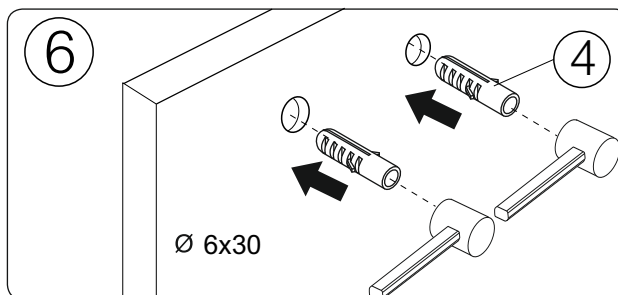

Hmoždinu č.4 vsunte do vyvrátenej diery.

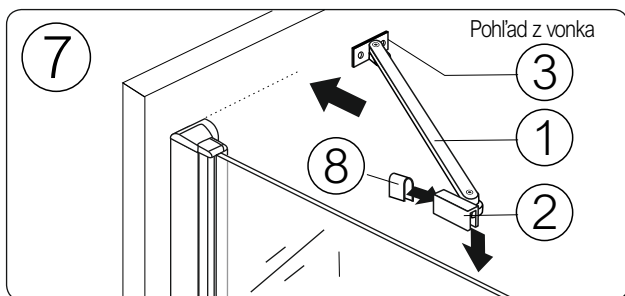

Konzoly diel č. 2 nasunte na pevné sklo a diel č.3 priložte ku stene.

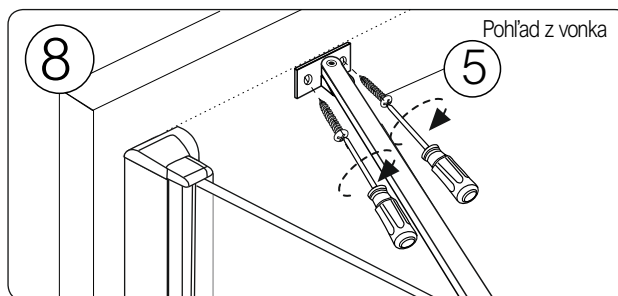

Skrutkovačom koncovku č.3 zafixujte šróbom č.5 (ST 6x30).

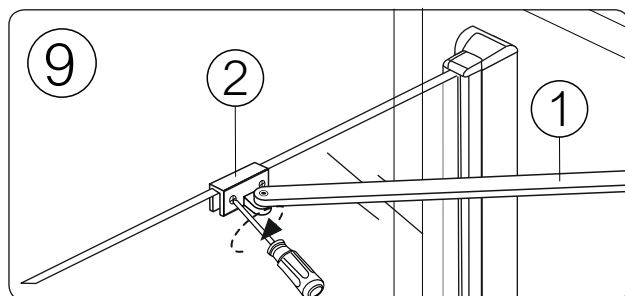

Skrutkovačom z vnútornej strany zafixujte zaisťovacie skrutky na diely č.2

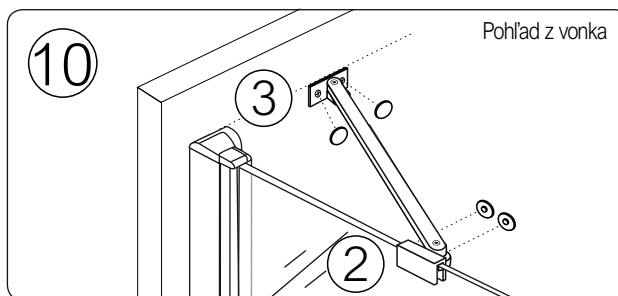

Nasadte krytky šróbov v dieloch č.2 a č.3.